

SIDES	BOTTOM
Material: Steel-0.213"-(C1008-C1018) Zinc Plated	

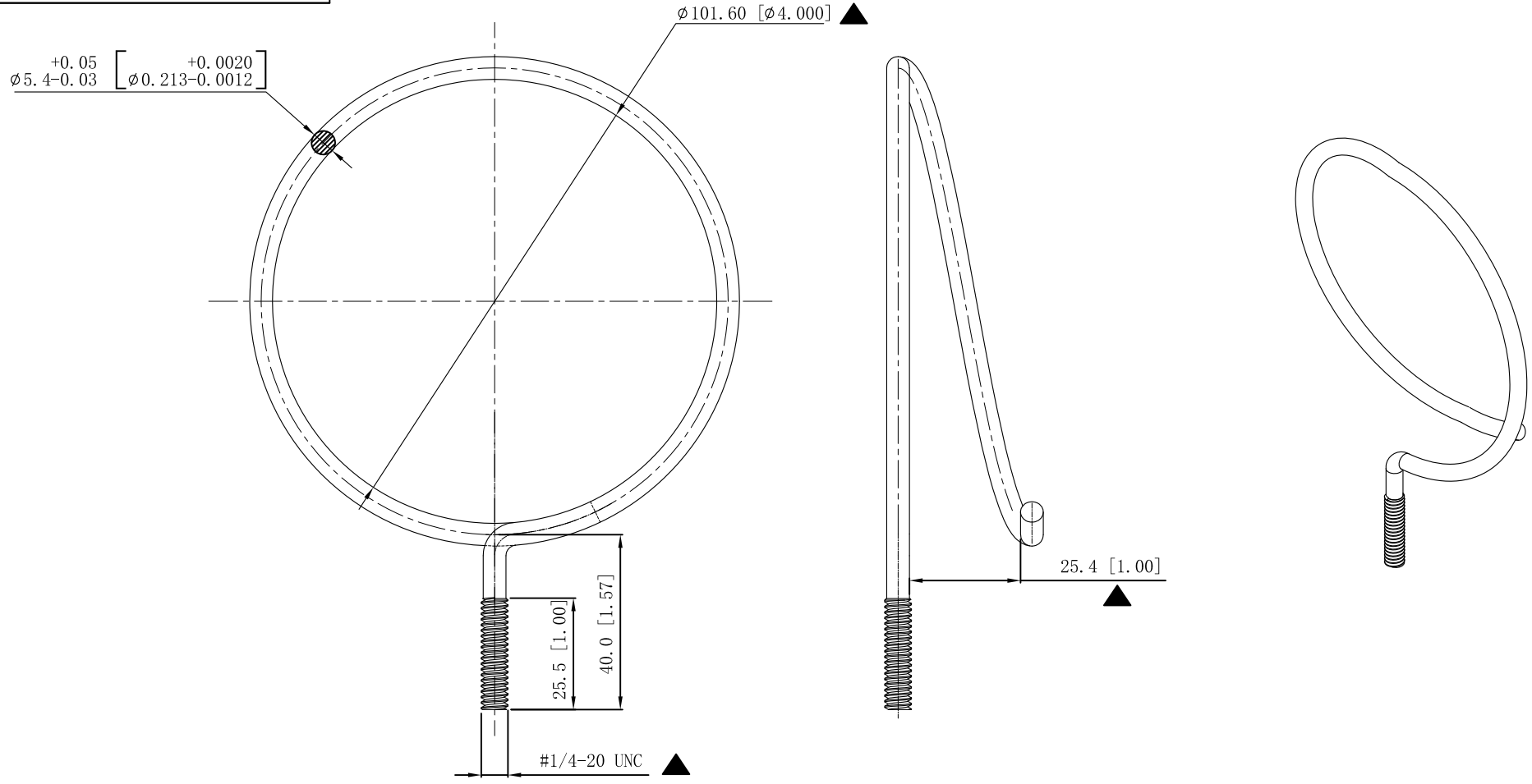

This data sheet is for reference only .GARVIN INDUSTRIES reserves the right to make changes to the design without prior notice.

DESCRIPTION
TRADE REFERENCE TERMS

STANDARD PACKING	ZHUJI SINO AMPLE METAL PRODUCTS CO. , LTD.		
50 PCS	TITLE MACHINE-SCREW BRIDLE RINGS		
	SIZE A4	DWG NO. SABR-400	REV A
DATA SHEET			